

# USER MANUAL (English)

## A4 AUDIO HANDSET

Item No. : 13535

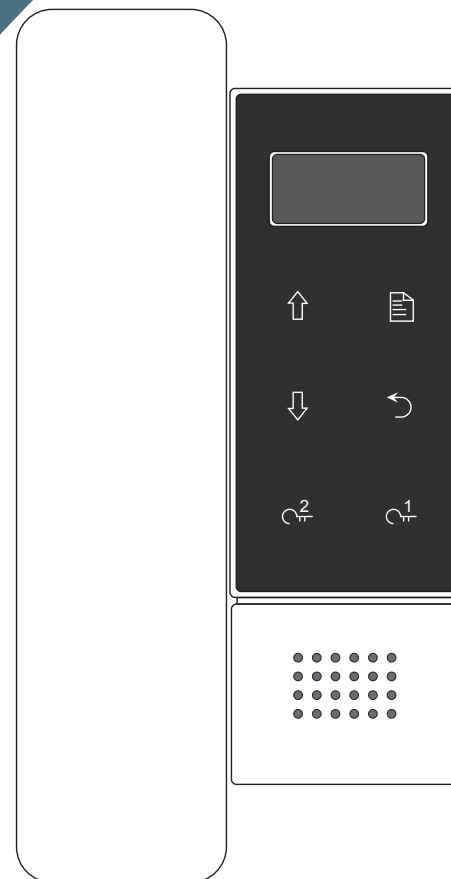

The design and specifications can be changed without notice to users.  
Copyright of this manual is reserved.

Version2.0.1.2.02.10

**ENTRY VUE**  
video intercom systems

# CONTENTS

1. Parts and Functions - - - - -	1
2. Key functions - - - - -	1
3. Operation Instructions - - - - -	2
4. Setup Instructions - - - - -	2
5. Specification - - - - -	4

## 1. Parts and Functions

### 1. A4 Audio Handset

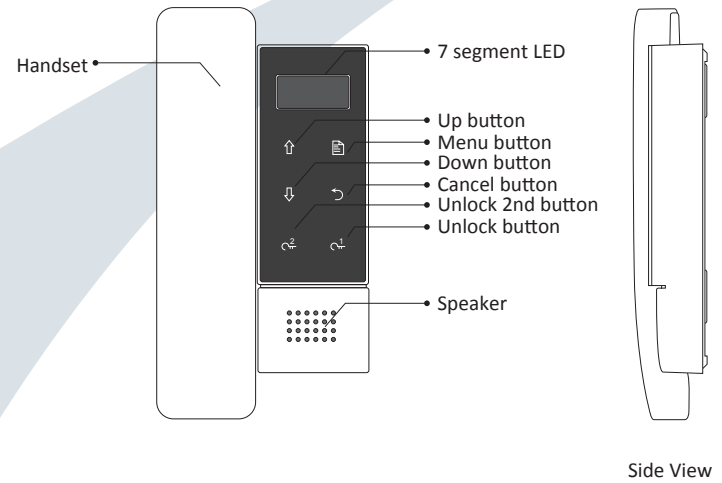

## 2. Key functions

7 segment LED	Display setting informations
Handset	Pick up to communicate with visitors
Hand line	Connect handset with monitor
Unlock button	Press to release the door
Unlock 2nd button	Press to release the second door
Up button	Press to move up or increase the value
Down button	Press to move down or decrease the value
Menu button	Press and hold for 2s to open the setting menu shortcuts.
Cancel button	Press to cancel the operations
Speaker	Send out voices from the visitors

### 3. Operation Instructions

**1) Door opening function:** When visitor calls from outdoor station, the monitor rings, pick up handset to talk to the visitors, then press the **Unlock** button to open the door. If the system connects 2 locks, press **Unlock 2nd** button to open the second door.

**2) Entrance monitoring:** Pick up handset in standby mode, the LED will show scrolling words "Intr Call", press **Up** button or **Down** button to stop the scroll, and the LED will show "ds-x" (x=1~4, refer to part 3-Numbers of door station), it means that the monitor selects "x" door stations to monitors. Press **Up / Down** button to increase/decrease value, then press **Menu** button to activate the monitoring function.

**3) Inner call:** Use **Up / Down** button to select "-ALL" on LED, then press **Menu** button to activate the inner call, function all monitors connected to the system will ring at the same time. Pick up any monitor, the others will stop ringing immediately. (note that the user code must be the same for all monitors in order to activate the inner call function)

**4) Intercom call:** Use **Up / Down** button to select "C-xx" (xx=00~31, refer to part 3-Numbers of indoor monitor) on LED, then press **Up / Down** button to increase/decrease the value, and press **Menu** button to confirm the intercom calling function. (note that the user code must be different for all monitors to activate the intercom call function)

### 4. Setup Instructions

Press **Menu** button and hold for 2s in standby mode, the LED will show scrolling word will "User Set-", press **Up** button or **Down** button to stop the scroll, and the LED show the setting items. Press **Menu** button to select next setting items.

Setting Item	LED State	Description	Default
Door Station call tone	1-xx	Set the ring tone calling from outdoor station. Total 12 ring tones can be selected (xx=01~12), press <b>Up</b> button or <b>Down</b> button to increase/decrease the value, settings will be performed immediately.	02
Intercom call tone	2-xx	Set the ring tone calling from intercom call or inner call. Total 12 ring tones can be selected (xx=01~12), press <b>Up / Down</b> button to increase/decrease the value, settings will be performed immediately.	12
Ring volume	3-rx	Set volume for speaker, adjust the voice from outdoor, rang from 0~9.	6
Speaker volume	4-Lx	Set volume for speaker, adjust the voice from outdoor, rang from 0~9.	6
Microphone volume	5-tx	Set volume for microphone, adjust the voice from user, rang from 0~9.	6
Numbers of door station	6-0x	Maximum 4 door stations can be selected, this item is used to set the numbers of door station that can be surveilled by indoor monitor. refer to part 2 -> Entrance Monitoring.	1
Numbers of indoor monitor	7-xx	Maximum 32 indoor monitors can be selected, this item is used to set the numbers of indoor monitor that can be selected to intercom. refer to part 2 -> Intercom call.	04
Keypad sensitivity	8-sx	Rang from 0~2, The larger you set the value, the stronger it will be, "0"-slow, "1"-normal, "2"-fast.	1
Slave address setting for monitor	9-dx	Rang from 0~3, "0"-master monitor, "1~3"-slave monitor.	0
Restore to default setting	9-FS	The restore to default function allows the user to recover the settings to factory setting. Select "9-FS" on LED, then press <b>Up</b> button, "YES" will be asked, press <b>Up</b> button again, the LED will be shown "SUCC", that means settings are restored to default.	-

## 5. Specification

- Power Supply: DC24V
- Power Consumption: Standby 20mA, working 70mA
- 7 segment LED: 4 digits dynamic
- Wiring: 2 wires, non-polarity
- Dimension: 187(H)X97(W)X33(D)mm